



**DUNDRUM VILLAGE STRATEGIC
HOUSING DEVELOPMENT (SHD) //
MAIN STREET, DUNDRUM, DUBLIN 14**

**Dundrum Retail GP DAC (ACTING
FOR AND ON BEHALF OF DUNDRUM
RETAIL LIMITED PARTNERSHIP)**

Part V Allocation

16 March / 2022

GRID
architects

00 Introduction

Document Purpose
Location of Part V Apartments

01 Floor Plans and Apartment Layouts

Ground and First Floor
Second and Third Floor
Fourth and Fifth Floor
Sixth and Seventh Floor
Eighth Floor

02 Elevations

South Elevation
West Elevation
North Elevation
East Elevation

03 Part V Schedules

Area Assessment and Accommodation Schedule

00 Introduction

Document Purpose and Executive Summary

Document Purpose

This document provides details of the Part V allocation of apartments in the proposed development.

It demonstrates that the proposals provide the 10% requirement. The apartments are of the required quality and meet or exceed the standards of the DSNAG planning policies. Further details can be found in the DVSHD - Housing Quality Standards report.

Location of Part V Apartments (Block 4A)

BLOCK 4A: 88No. Units

The scheme includes for the Part V Social Housing Provision of 88 No. units located within Block 4A (Ground to Eighth Floor)

9.98% of overall development (88/881)

These comprise of:

- 46 No. 1beds;
- 37 No. 2 beds; and
- 5 No. 3 beds

OVERALL SITE AREA: 35335 m2

3.5335 ha

 Proposed Part V Units



First Floor Plan

01 Floor Plans and Apartment Layouts

01 FLOOR PLANS AND APARTMENT LAYOUTS

Floor Plans Block 4A

LEVEL 0 - PART V

1 Beds	4 units
2 Beds	3 units
3 Beds	0 units
Sub Total:	7 units
Dual Aspect:	5 units

GROUND FLOOR
LEVEL - BLOCK 4A
SCALE 1:250



LEVEL 1 - PART V

1 Beds	7 units
2 Beds	5 units
3 Beds	0 units
Sub Total:	12 units
Dual Aspect:	8 units

FIRST FLOOR
LEVEL - BLOCK 4A
SCALE 1:250



- 1 Bed 2 Persons
- 2 Bed 4 Persons
- 3 Bed 5 Persons
- Proposed Part V Units

SCALE 1:500 AT A1

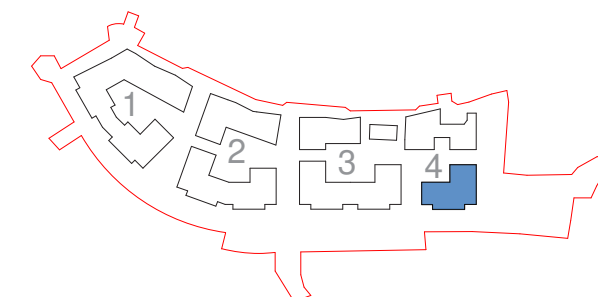

Floor Plans Block 4A

LEVEL 2 - PART V

1 Beds	7 units
2 Beds	5 units
3 Beds	0 units

Sub Total: **12 units**
Dual Aspect: **8 units**

SECOND FLOOR
LEVEL - BLOCK 4A
SCALE 1:250



- 1 Bed 2 Persons
- 2 Bed 4 Persons
- 3 Bed 5 Persons
- Proposed Part V Units

SCALE 1:500 AT A1

LEVEL 3 - PART V

1 Beds	7 units
2 Beds	5 units
3 Beds	0 units

Sub Total: **12 units**
Dual Aspect: **8 units**

THIRD FLOOR
LEVEL - BLOCK 4A
SCALE 1:250

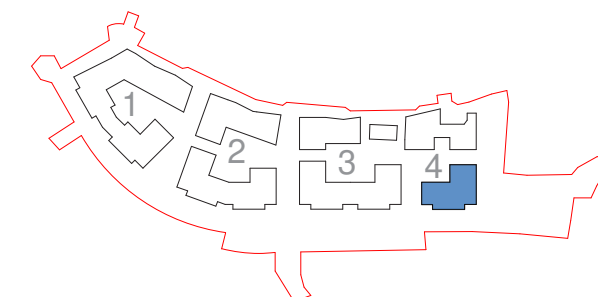

Floor Plans Block 4A

LEVEL 4 - PART V

1 Beds	5 units
2 Beds	5 units
3 Beds	1 units

Sub Total: **11 units**
Dual Aspect: **8 units**

FOURTH FLOOR
LEVEL - BLOCK 4A
SCALE 1:250



LEVEL 5 - PART V

1 Beds	5 units
2 Beds	5 units
3 Beds	1 units

Sub Total: **11 units**
Dual Aspect: **8 units**

FIFTH FLOOR
LEVEL - BLOCK 4A
SCALE 1:250



- 1 Bed 2 Persons
- 2 Bed 4 Persons
- 3 Bed 5 Persons
- Proposed Part V Units

SCALE 1:500 AT A1

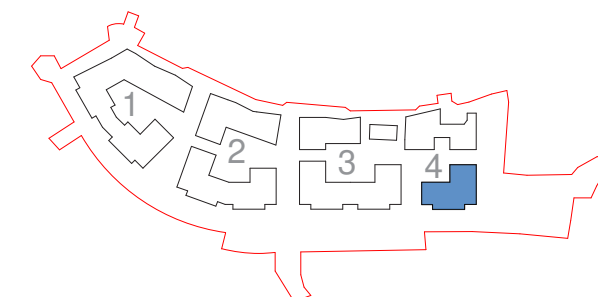

01 FLOOR PLANS AND APARTMENT LAYOUTS

Floor Plans Block 4A

LEVEL 6 - PART V

1 Beds	5 units
2 Beds	5 units
3 Beds	1 units
Sub Total:	11 units
Dual Aspect:	8 units

SIXTH FLOOR
LEVEL - BLOCK 4A
SCALE 1:250



- 1 Bed 2 Persons
- 2 Bed 4 Persons
- 3 Bed 5 Persons
- Proposed Part V Units

SCALE 1:500 AT A1

LEVEL 7 - PART V

1 Beds	3 units
2 Beds	2 units
3 Beds	1 units
Sub Total:	6 units
Dual Aspect:	4 units

SEVENTH FLOOR
LEVEL - BLOCK 4A
SCALE 1:250

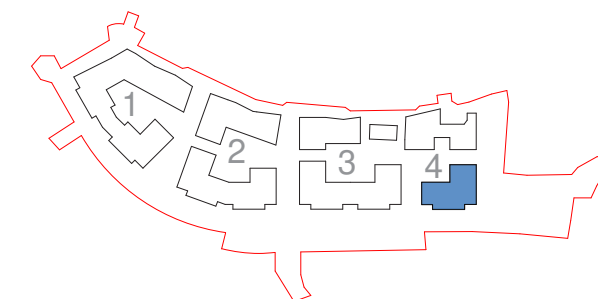

01 FLOOR PLANS AND APARTMENT LAYOUTS

Floor Plans Block 4A

LEVEL 8 - PART V

1 Beds	3 units
2 Beds	2 units
3 Beds	1 units

Sub Total: **6 units**
Dual Aspect: **4 units**

EIGHTH FLOOR
LEVEL - BLOCK 4A
SCALE 1:250



- 1 Bed 2 Persons
- 2 Bed 4 Persons
- 3 Bed 5 Persons
- Proposed Part V Units

SCALE 1:500 AT A1

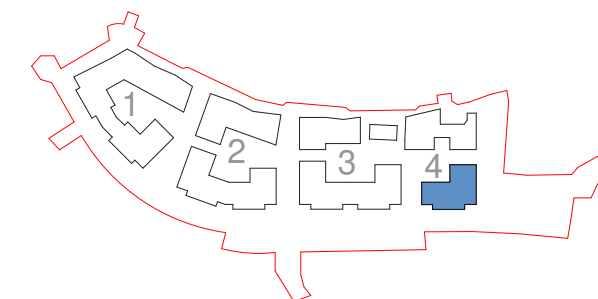

02 Elevations

02 ELEVATIONS

Elevation Block 4A - South Facade



--- Outline Denotes Overall Site Boundary

SCALE 1:500 AT A1

Key Value	Description
01	Glass
08	Metal Frame
09	Metal Panel
16	Dark Brick Dark Mortar
22	Red Brick Dark Mortar
29	Light Grey Brick Dark Mortar
36	Light Red Brick Light Mortar
38	Light Grey Brick Light Mortar
39	Light Grey Brick Light Mortar Corbel 1
40	Light Recess Balcony with Metal Surround

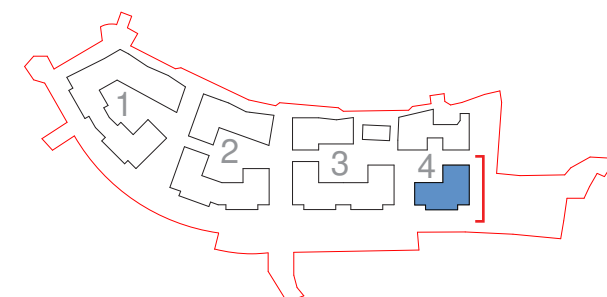



--- Outline Denotes Overall Site Boundary

SCALE 1:500 AT A1

Key Value	Description
01	Glass
08	Metal Frame
09	Metal Panel
16	Dark Brick Dark Mortar
22	Red Brick Dark Mortar
29	Light Grey Brick Dark Mortar
36	Light Red Brick Light Mortar
38	Light Grey Brick Light Mortar
39	Light Grey Brick Light Mortar Corbel 1
40	Light Recess Balcony with Metal Surround

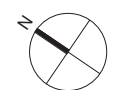
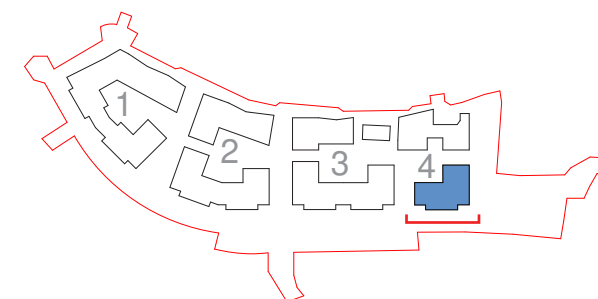

02 ELEVATIONS

Elevation Block 4A - North Facade



--- Outline Denotes Overall Site Boundary

SCALE 1:500 AT A1

Key Value	Description
01	Glass
08	Metal Frame
09	Metal Panel
16	Dark Brick Dark Mortar
22	Red Brick Dark Mortar
29	Light Grey Brick Dark Mortar
36	Light Red Brick Light Mortar
38	Light Grey Brick Light Mortar
39	Light Grey Brick Light Mortar Corbel 1
40	Light Recess Balcony with Metal Surround

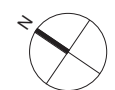
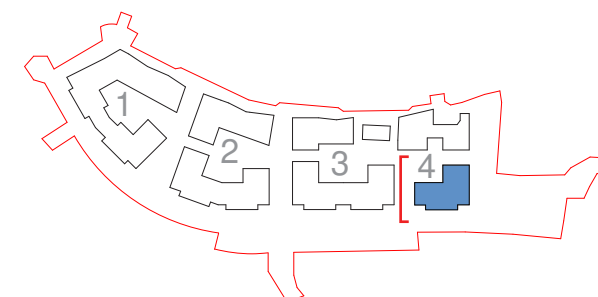



--- Outline Denotes Overall Site Boundary

SCALE 1:500 AT A1

Key Value	Description
01	Glass
08	Metal Frame
09	Metal Panel
16	Dark Brick Dark Mortar
22	Red Brick Dark Mortar
29	Light Grey Brick Dark Mortar
36	Light Red Brick Light Mortar
38	Light Grey Brick Light Mortar
39	Light Grey Brick Light Mortar Corbel 1
40	Light Recess Balcony with Metal Surround

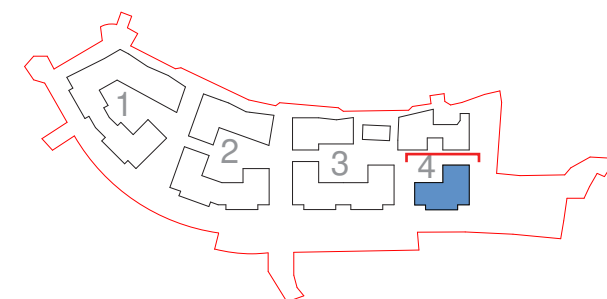

03 Part V Schedules

Part V - Area Assessment + Accommodation schedule

PRINCIPAL STATISTICS							
BLOCK	Level	Unit number	Unit Type	Bedroom Count	Unit Description	Unit Area m ²	Minimum Unit Area m ²
4A	P00	754	1B2P-13	1	1B2P	49.9	45
4A	P00	755	1B2P-13	1	1B2P	49.9	45
4A	P00	756	2B4P-14	2	2B4P	73.1	73
4A	P00	757	1B2P-22	1	1B2P	51.6	45
4A	P00	758	2B4P-15	2	2B4P	73.4	73
4A	P00	759	2B4P-16	2	2B4P	78.4	73
4A	P00	760	1B2P-30	1	1B2P	57.7	45
4A	P01	761	1B2P-1	1	1B2P	50.4	45
4A	P01	762	1B2P-23	1	1B2P	50.8	45
4A	P01	763	1B2P-13	1	1B2P	49.9	45
4A	P01	764	1B2P-13	1	1B2P	49.9	45
4A	P01	765	2B4P-14	2	2B4P	73.1	73
4A	P01	766	1B2P-22	1	1B2P	51.6	45
4A	P01	767	2B4P-15	2	2B4P	73.4	73
4A	P01	768	2B4P-16	2	2B4P	78.4	73
4A	P01	769	1B2P-2	1	1B2P	51.2	45
4A	P01	770	2B4P-4	2	2B4P	74.3	73
4A	P01	771	2B4P-4	2	2B4P	74.3	73
4A	P01	772	1B2P-24	1	1B2P	49.5	45
4A	P02	773	1B2P-1	1	1B2P	50.4	45
4A	P02	774	1B2P-23	1	1B2P	50.8	45
4A	P02	775	1B2P-13	1	1B2P	49.9	45
4A	P02	776	1B2P-13	1	1B2P	49.9	45
4A	P02	777	2B4P-14	2	2B4P	73.1	73
4A	P02	778	1B2P-22	1	1B2P	51.6	45
4A	P02	779	2B4P-15	2	2B4P	73.4	73
4A	P02	780	2B4P-16	2	2B4P	78.4	73
4A	P02	781	1B2P-2	1	1B2P	51.2	45
4A	P02	782	2B4P-4	2	2B4P	74.3	73
4A	P02	783	2B4P-4	2	2B4P	74.3	73
4A	P02	784	1B2P-24	1	1B2P	49.5	45
4A	P03	785	1B2P-1	1	1B2P	50.4	45
4A	P03	786	1B2P-23	1	1B2P	50.8	45
4A	P03	787	1B2P-13	1	1B2P	49.9	45
4A	P03	788	1B2P-13	1	1B2P	49.9	45
4A	P03	789	2B4P-14	2	2B4P	73.1	73
4A	P03	790	1B2P-22	1	1B2P	51.6	45
4A	P03	791	2B4P-15	2	2B4P	73.4	73
4A	P03	792	2B4P-16	2	2B4P	78.4	73
4A	P03	793	1B2P-2	1	1B2P	51.2	45
4A	P03	794	2B4P-4	2	2B4P	74.3	73
4A	P03	795	2B4P-4	2	2B4P	74.3	73
4A	P03	796	1B2P-24	1	1B2P	49.5	45
4A	P04	797	3B5P-7	3	3B5P	103.9	90
4A	P04	798	1B2P-13	1	1B2P	49.9	45
4A	P04	799	1B2P-13	1	1B2P	49.9	45
4A	P04	800	2B4P-14	2	2B4P	73.1	73
4A	P04	801	1B2P-22	1	1B2P	51.6	45
4A	P04	802	2B4P-15	2	2B4P	73.4	73
4A	P04	803	2B4P-16	2	2B4P	78.4	73
4A	P04	804	1B2P-2	1	1B2P	51.2	45
4A	P04	805	2B4P-4	2	2B4P	74.3	73
4A	P04	806	2B4P-4	2	2B4P	74.3	73
4A	P04	807	1B2P-24	1	1B2P	49.5	45
4A	P05	808	3B5P-7	3	3B5P	103.9	90
4A	P05	809	1B2P-13	1	1B2P	49.9	45
4A	P05	810	1B2P-13	1	1B2P	49.9	45
4A	P05	811	2B4P-14	2	2B4P	73.1	73
4A	P05	812	1B2P-22	1	1B2P	51.6	45
4A	P05	813	2B4P-15	2	2B4P	73.4	73

4A	P05	814	2B4P-16	2	2B4P	78.4	73
4A	P05	815	1B2P-2	1	1B2P	51.2	45
4A	P05	816	2B4P-4	2	2B4P	74.3	73
4A	P05	817	2B4P-4	2	2B4P	74.3	73
4A	P05	818	1B2P-24	1	1B2P	49.5	45
4A	P06	819	3B5P-7	3	3B5P	103.9	90
4A	P06	820	1B2P-13	1	1B2P	49.9	45
4A	P06	821	1B2P-13	1	1B2P	49.9	45
4A	P06	822	2B4P-14	2	2B4P	73.1	73
4A	P06	823	1B2P-22	1	1B2P	51.6	45
4A	P06	824	2B4P-15	2	2B4P	73.4	73
4A	P06	825	2B4P-16	2	2B4P	78.4	73
4A	P06	826	1B2P-2	1	1B2P	51.2	45
4A	P06	827	2B4P-4	2	2B4P	74.3	73
4A	P06	828	2B4P-4	2	2B4P	74.3	73
4A	P06	829	1B2P-24	1	1B2P	49.5	45
4A	P07	830	1B2P-13	1	1B2P	49.9	45
4A	P07	831	1B2P-13	1	1B2P	49.9	45
4A	P07	832	2B4P-14	2	2B4P	73.1	73
4A	P07	833	1B2P-22	1	1B2P	51.6	45
4A	P07	834	2B4P-15	2	2B4P	73.4	73
4A	P07	835	3B5P-9	3	3B5P	103.3	90
4A	P08	836	1B2P-13	1	1B2P	49.9	45
4A	P08	837	1B2P-13	1	1B2P	49.9	45
4A	P08	838	2B4P-14	2	2B4P	73.1	73
4A	P08	839	1B2P-22	1	1B2P	51.6	45
4A	P08	840	2B4P-15	2	2B4P	73.4	73
4A	P08	841	3B5P-9	3	3B5P	103.3	90

Block 4A	Studio	1 Bed	2 Bed 3P	2 Bed 4P	3 Bed	Total
P99	0	0	0	0	0	0
P00	0	4	0	3	0	7
P01	0	7	0	5	0	12
P02	0	7	0	5	0	12
P03	0	7	0	5	0	12
P04	0	5	0	5	1	11
P05	0	5	0	5	1	11
P06	0	5	0	5	1	11
P07	0	3	0	2	1	6
P08	0	3	0	2	1	6
Total	0	46	0	37	5	88